





88 Guan Road, Brockworth

£320,000

 3  2  1

- SEMI DETACHED
- 3 GENEROUS BEDROOMS
- OPEN PLAN KITCHEN/DINER
- SEPARATE LIVING ROOM
- WELL LOCATED FOR AMENITIES
- DAVID WILSON BUILT HOME
- LARGE SOUTH FACING REAR GARDEN
- WC, BATHROOM AND EN-SUITE
- GARAGE AND PARKING
- REF DH0109



REF DH0109; I am delighted to present this David Wilson built semi detached home in Guan Road, Coopers Edge. The home is set in a surprisingly spacious plot with a large south facing rear garden, garage and parking space. The home is well designed for modern living with a well appointed kitchen/diner to front and a spacious and yet cosy living room to rear. Upstairs there are three generous bedrooms with master having en-suite and built in wardrobes. The property is complete with ground floor WC and first floor bathroom.



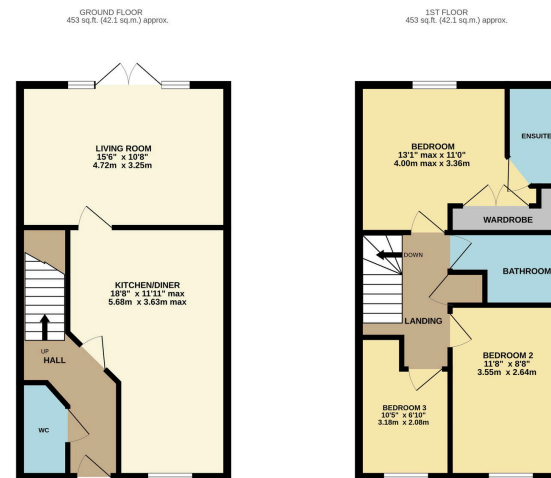

TOTAL FLOOR AREA: 906 sq.ft. (84.2 sq.m.) approx.

906 sq.ft. (84.2 sq.m.) approx. is based on the measurements of the finished condition from measurements of doors, windows, main and any other doors are approximated and the responsibility is taken for any errors. Although we are confident, this does not constitute a guarantee. The floor area is measured to the internal face of the walls, columns, supports and projections unless they have been noted and so guaranteed. All measurements are in feet and inches. Measurements are taken to the best of our ability and no guarantee is given. Measurements are taken to the best of our ability and no guarantee is given. Measurements are taken to the best of our ability and no guarantee is given.

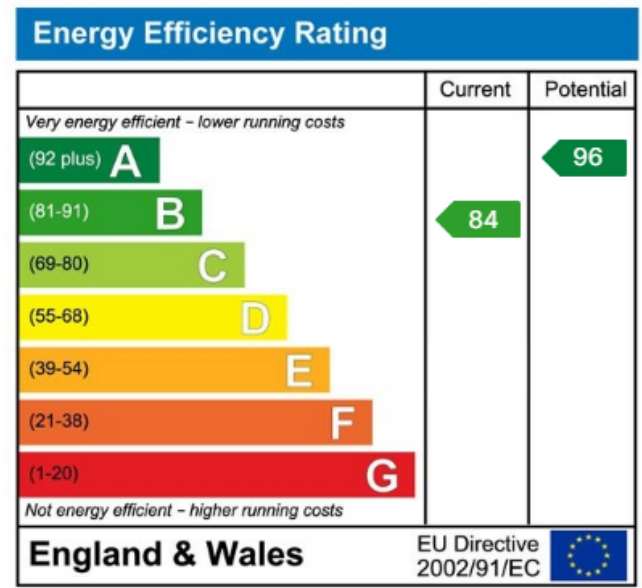

eXp World UK Ltd is a registered company at Level 37, 25 Canada Square, London, E14 5LQ.
Registered company number is 12016573. VAT Registration Number is 327 4120 29